



Adobe Illustrator

2022
release



Classroom in a Book®

The official training workbook from Adobe

Brian Wood

FREE SAMPLE CHAPTER

SHARE WITH OTHERS





Adobe Illustrator

2022
release



Classroom in a Book[®]

The official training workbook from Adobe
Brian Wood

Adobe Illustrator Classroom in a Book® (2022 release)

© 2022 Adobe. All rights reserved.

Adobe Press is an imprint of Pearson Education, Inc. For the latest on Adobe Press books, go to www.adobepress.com. To report errors, please send a note to errata@peachpit.com. For information regarding permissions, request forms and the appropriate contacts within the Pearson Education Global Rights & Permissions department, please visit www.pearson.com/permissions.

If this guide is distributed with software that includes an end user license agreement, this guide, as well as the software described in it, is furnished under license and may be used or copied only in accordance with the terms of such license. Except as permitted by any such license, no part of this guide may be reproduced, stored in a retrieval system, or transmitted, in any form or by any means, electronic, mechanical, recording, or otherwise, without the prior written permission of Adobe. Please note that the content in this guide is protected under copyright law even if it is not distributed with software that includes an end user license agreement. The content of this guide is furnished for informational use only, is subject to change without notice, and should not be construed as a commitment by Adobe. Adobe assumes no responsibility or liability for any errors or inaccuracies that may appear in the informational content contained in this guide.

Please remember that existing artwork or images that you may want to include in your project may be protected under copyright law. The unauthorized incorporation of such material into your new work could be a violation of the rights of the copyright owner. Please be sure to obtain any permission required from the copyright owner. Any references to company names in sample files are for demonstration purposes only and are not intended to refer to any actual organization.

Adobe, the Adobe logo, Acrobat, Classroom in a Book, Creative Cloud, Creative Cloud logo, Dreamweaver, Flash, Illustrator, InDesign, Photoshop, and PostScript are either registered trademarks or trademarks of Adobe in the United States and/or other countries. Adobe product screenshots reprinted with permission from Adobe.

Apple, Safari, Mac, macOS, and Macintosh are trademarks of Apple Inc., registered in the U.S. and other countries. Microsoft, Windows, Windows XP, Windows 7, and Windows 8 are either registered trademarks or trademarks of Microsoft Corporation in the U.S. and/or other countries. Wacom and Intuos are trademarks of Wacom Company Ltd. PANTONE®, myPANTONE™ and other Pantone LLC properties are trademarks or registered trademarks of Pantone LLC in the United States and other countries. All rights reserved. NVIDIA is a trademark and/or registered trademark of NVIDIA Corporation in the U.S. and/or other countries. All other trademarks are the property of their respective owners. Unless otherwise indicated herein, any third party trademarks that may appear in this work are the property of their respective owners and any references to third party trademarks, logos or other trade dress are for demonstrative or descriptive purposes only. Such references are not intended to imply any sponsorship, endorsement, authorization, or promotion of Pearson Education, Inc. products by the owners of such marks, or any relationship between the owner and Pearson Education, Inc. or its affiliates, authors, licensees or distributors.

Adobe Inc., 345 Park Avenue, San Jose, California 95110-2704, USA

Notice to U.S. Government End Users. The Software and Documentation are “Commercial Items,” as that term is defined at 48 C.F.R. §2.101, consisting of “Commercial Computer Software” and “Commercial Computer Software Documentation,” as such terms are used in 48 C.F.R. §12.212 or 48 C.F.R. §227.7202, as applicable. Consistent with 48 C.F.R. §12.212 or 48 C.F.R. §§227.7202-1 through 227.7202-4, as applicable, the Commercial Computer Software and Commercial Computer Software Documentation are being licensed to U.S. Government end users (a) only as Commercial Items and (b) with only those rights as are granted to all other end users pursuant to the terms and conditions herein. Unpublished rights reserved under the copyright laws of the United States. Adobe Inc., 345 Park Avenue, San Jose, CA 95110-2704, USA. For U.S. Government End Users, Adobe agrees to comply with all applicable equal opportunity laws including, if appropriate, the provisions of Executive Order 11246, as amended, Section 402 of the Vietnam Era Veterans Readjustment Assistance Act of 1974 (38 USC 4212), and Section 503 of the Rehabilitation Act of 1973, as amended, and the regulations at 41 CFR Parts 60-1 through 60-60, 60-250, and 60-741. The affirmative action clause and regulations contained in the preceding sentence shall be incorporated by reference.

Cover Illustration: Petra Eriksson, Barcelona, Spain

ISBN-13: 978-0-13-762215-3

ISBN-10: 0-13-762215-5

ScoutAutomatedPrintCode

WHERE ARE THE LESSON FILES?

Purchase of this Classroom in a Book in any format gives you access to the lesson files you'll need to complete the exercises in the book.

- 1 Go to adobe.com/illustratorCIB2022.
- 2 Sign in or create a new account.
- 3 Click Submit.

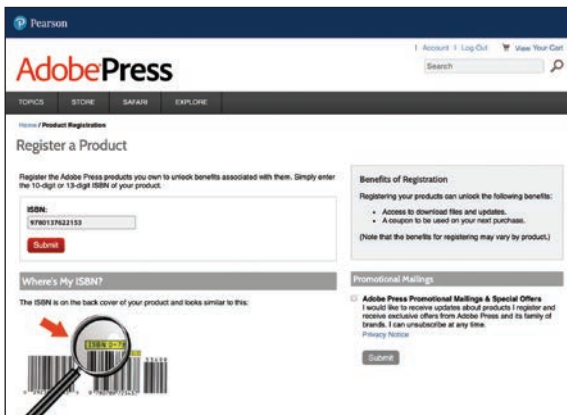

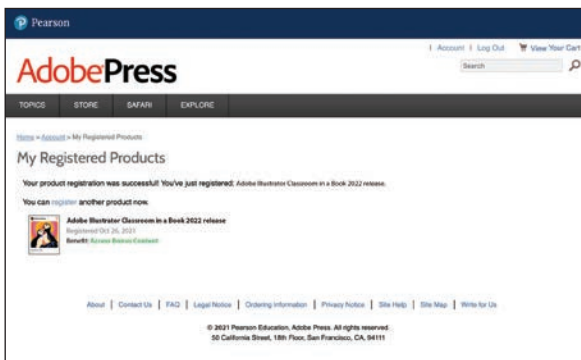

● **Note:** If you encounter problems registering your product or accessing the lesson files or web edition, go to adobe.com/support for assistance.

- 4 Answer the questions as proof of purchase.
- 5 The lesson files can be accessed through the Registered Products tab on your Account page.
- 6 Click the Access Bonus Content link below the title of your product to proceed to the download page. Click the lesson file links to download them to your computer.

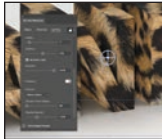

● **Note:** If you purchased a digital product directly from adobe.com or peachpit.com, your product will already be registered. However, you still need to follow the registration steps and answer the proof of purchase question before the Access Bonus Content link will appear under the product on your Registered Products tab.

CONTENTS

GETTING STARTED	1
About Classroom in a Book®	1
Prerequisites	1
Installing the program	2
Fonts used in this book	2
Online Content	2
Lesson files	2
Web Edition	3
Accessing the lesson files and Web Edition	3
Restoring default preferences	4
To delete or save the current Illustrator preferences file	4
To restore saved preferences after completing the lessons ..	5
Additional resources	5
Adobe Authorized Training Partners	5
WHAT'S NEW IN ADOBE ILLUSTRATOR (2022 RELEASE)	6
	
Apply 3D effects and materials	6
Share for collaborative commenting	6
Find what you need with the Discover panel	7
Other enhancements	7
A QUICK TOUR OF ADOBE ILLUSTRATOR (2022 RELEASE)	8
	
Starting the lesson	10
Creating a new document	10
Drawing shapes	12
Editing shapes	13
Combine shapes using the Shape Builder tool	14
Applying and editing color	15
Transforming artwork	17
Recoloring artwork	18
Creating and editing a gradient	19
Editing strokes	21
Creating with the Curvature tool	21

Applying a brush	22
Working with type	23
Warping text	24
Working with effects	25
Adding more text for practice	26
Aligning artwork	27

1 GETTING TO KNOW THE WORK AREA 28



Introducing Adobe Illustrator	30
Opening an Illustrator file	31
Exploring the workspace	33
Getting to know the toolbar	34
Finding more tools	36
Working with the Properties panel	38
Working with panels	39
Moving and docking panels	40
Switching workspaces	42
Saving a workspace	43
Using panel and context menus	44
Changing the view of artwork	46
Using view commands	46
Using the Zoom tool	48
Panning in a document	50
Panning with the Navigator panel 	50
Viewing artwork	50
Navigating multiple artboards	51
Rotating the view	54
Arranging multiple documents	55

2 TECHNIQUES FOR SELECTING ARTWORK 58



Starting the lesson	60
Selecting objects	61
Using the Selection tool	61
Selecting and editing with the Direct Selection tool	63
Selecting with a marquee	65
Hiding and locking objects	66
Unlocking objects	67

Selecting similar objects	68
Selecting in Outline mode	69
Aligning objects	70
Aligning objects to each other	70
Aligning to a key object	71
Distributing objects	72
Aligning anchor points	73
Aligning to the artboard	74
Working with groups	75
Grouping items	75
Editing a group in Isolation mode	77
Creating a nested group	78
Exploring object arrangement	79
Arranging objects	79

3 USING SHAPES TO CREATE ARTWORK FOR A POSTCARD 82



Starting the lesson	84
Creating a new document	84
Working with basic shapes	87
Creating rectangles	87
Editing rectangles	88
Rounding corners	90
Rounding individual corners	91
Creating and editing ellipses	93
Creating and editing circles	94
Changing stroke width and alignment	96
Creating a polygon	97
Editing the polygon	98
Creating a star	100
Editing the star	101
Drawing lines	102
Using Image Trace to convert images into editable vector art ..	103
Cleaning up traced artwork	105
Working with drawing modes	106
Placing artwork	107
Using Draw Inside mode	107
Editing content drawn inside	108
Working with Draw Behind mode	109
Finishing up	110

4 EDITING AND COMBINING SHAPES AND PATHS 112





Starting the lesson	114
Editing paths and shapes	115
Cutting with the Scissors tool	115
Joining paths	117
Cutting with the Knife tool	118
Cutting in a straight line with the Knife tool	119
Outlining strokes	121
Using the Eraser tool	122
Erasing in a straight line	123
Assemble the first dinosaur	124
Creating a compound path	124
Combining shapes	126
Start by creating a shape	126
Working with the Shape Builder tool	127
Assemble the second dinosaur	129
Combining objects using Pathfinder effects	130
Understanding shape modes	131
Reshaping a path	133
Using the Width tool	134
Assemble the last dinosaur	136

5 TRANSFORMING ARTWORK 138



Starting the lesson	140
Working with artboards	141
Drawing a custom-sized artboard	141
Creating a new artboard	142
Editing artboards	143
Copying artboards between documents	145
Aligning and arranging artboards	146
Setting options for artboards	148
Reordering artboards	148
Working with rulers and guides	150
Creating guides	150
Editing the ruler origin 	152
Transforming content	152
Working with the bounding box	152
Positioning artwork using the Properties panel	153

Scaling objects precisely	154
Rotating objects with the Rotate tool	155
Scale using Transform Each	156
Shearing objects	156
Transforming with the Free Transform tool 	158
Using repeats	158
Applying a mirror repeat	158
Editing a mirror repeat	160
Using grid and radial repeats 	161
Adding the Puppet Warp tool to the toolbar	161
Adding pins	161
Rotating pins	163

6 USING THE BASIC DRAWING TOOLS 166

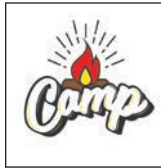

Starting the lesson	168
Creating with the Curvature tool	169
Drawing paths with the Curvature tool	169
Drawing a river path	170
Editing a path with the Curvature tool	172
Creating corners with the Curvature tool	173
Creating dashed lines	175
Creating with the Pencil tool	177
Drawing paths with the Pencil tool	177
Drawing straight lines with the Pencil tool	178
Joining with the Join tool	180
Finishing the Camp logo	181
Adding arrowheads to paths	182

7 DRAWING WITH THE PEN TOOL 184

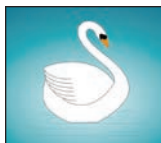

Starting the lesson	186
Why use the Pen tool?	186
What can you create with the Pen tool?	187
Starting with the Pen tool	187
Creating straight lines to make a crown	187
Adding some color to the crown	189
Selecting and editing paths in the crown	189
Drawing a house with the Pen tool	190
Adding some color to the house	192
Starting with curved paths	192





Drawing a curve with the Pen tool	193
Drawing a series of curves with the Pen tool	194
Converting smooth points to corner points	195
Combining curves and straight lines	197
Creating artwork with the Pen tool	199
Drawing the swan	200
Editing paths and points	204
Deleting and adding anchor points	204
Converting between smooth points and corner points	206
Converting anchors with the Anchor Point tool	207
Practice with the Convert Anchor point tool	208

8 USING COLOR TO ENHANCE ARTWORK 210



Starting the lesson	212
Exploring color modes	213
Working with color	214
Applying an existing color	214
Creating a custom color	215
Saving a color as a swatch	216
Creating a copy of a swatch	217
Editing a global swatch	218
Editing a non-global swatch	219
Using the Color Picker to create color	221
Using Illustrator swatch libraries	223
Adding a spot color	224
Creating and saving a tint of a color	225
Converting colors	226
Copying appearance attributes	226
Creating a color group	227
Using the Color Guide panel for creative inspiration	228
Using Recolor Artwork to edit colors in artwork	231
Recoloring artwork	231
Sampling color	233
Working with Live Paint	235
Creating a Live Paint group	235
Painting with the Live Paint Bucket tool	236
Modifying a Live Paint group	238



Starting the lesson	242
Adding text	243
Adding text at a point	243
Adding area type	244
Converting between area type and point type	246
Area type auto sizing 	246
Importing a plain-text file	247
Threading text	248
Formatting type	250
Changing font family and font style	250
Activating Adobe Fonts	250
Applying fonts to text in Illustrator	252
Fixing missing fonts 	253
Changing font size	254
Changing the color of the text	255
Changing additional character formatting	256
Changing paragraph formatting	257
Working with glyphs 	258
Vertically aligning area type	259
Using glyph snapping 	259
Resizing and reshaping type objects	260
Creating columns of text	260
Reshaping type objects	261
Sampling text formatting	261
Creating and applying text styles	262
Creating and applying a paragraph style	262
Practicing paragraph styles	264
Editing a paragraph style	265
Creating and applying a character style	265
Editing a character style	267
Wrapping text	268
Curving text on a path	269
Warping text	270
Reshaping text with a preset envelope warp	270
Editing the envelope warp	271
Creating text outlines	272

10 ORGANIZING YOUR ARTWORK WITH LAYERS 274



Starting the lesson 276

- Understanding layers 277

Creating layers and sublayers 278

- Creating new layers 278
- Creating a sublayer 280

Editing layers and objects 280

- Finding content in the Layers panel 280
- Moving content between layers 283
- Viewing layer content differently 285
- Reordering layers and content 287
- Locking and hiding layers 289
- Duplicating layer content 291
- Pasting layers 292
- Applying appearance attributes to a layer 294

Creating a clipping mask 295

11 GRADIENTS, BLENDS, AND PATTERNS 298



Starting the lesson 300

Working with gradients 301

- Applying a linear gradient to a fill 302
- Editing a gradient 302
- Saving a gradient as a swatch 303
- Adjusting a linear gradient fill 304
- Applying a linear gradient to a stroke 306
- Editing a gradient on a stroke 307
- Applying a radial gradient to artwork 309
- Editing the colors in the radial gradient 310
- Adjusting the radial gradient 310
- Applying gradients to multiple objects 312
- Adding transparency to gradients 313
- Applying a freeform gradient 314
- Editing a freeform gradient in Points mode 315
- Applying color stops in Lines mode 316

Working with blended objects 317

- Creating a blend with specified steps 318
- Modifying a blend 319
- Creating and editing a smooth color blend 320

Creating patterns	322
Applying an existing pattern	322
Creating your own pattern	323
Applying your pattern	325
Editing your pattern	326

12 USING BRUSHES TO CREATE AN AD 328



Starting the lesson	330
Working with brushes	331
Using Calligraphic brushes	331
Types of brushes	331
Applying a Calligraphic brush to artwork	332
Editing a brush	333
Drawing with the Paintbrush tool	334
Editing paths with the Paintbrush tool	336
Removing a brush stroke	338
Using Art brushes	339
Applying an existing Art brush	339
Creating an Art brush	340
Editing an Art brush	341
Using Pattern brushes	344
Creating a Pattern brush	345
Applying a Pattern brush	347
Editing the Pattern brush	348
Using Bristle brushes	350
Changing Bristle brush options	350
Painting with a Bristle brush	351
Grouping Bristle brush paths	352
Working with the Blob Brush tool	352
Drawing with the Blob Brush tool	352
Editing with the Eraser tool	354

13 EXPLORING CREATIVE USES OF EFFECTS AND GRAPHIC STYLES 356



Starting the lesson	358
Using the Appearance panel	360
Editing appearance attributes	361
Adding another fill to content	362
Adding multiple strokes and fills to text	364
Reordering appearance attributes	367
Using live effects	368

Applying an effect	369
Editing an effect	370
Styling text with a Warp effect	371
Temporarily disabling effects to make edits	372
Applying other effects	372
Applying a Photoshop effect	375
Working with 3D and Materials 	376
Using graphic styles	376
Applying an existing graphic style	377
Creating and applying a graphic style	378
Updating a graphic style	379
Applying a graphic style to a layer	380
Scaling strokes and effects	381

14 CREATING ARTWORK FOR A T-SHIRT 384



Starting the lesson	386
Working with symbols	387
Using default Illustrator symbol libraries	387
Editing a symbol	390
Working with dynamic symbols	391
Creating a symbol	392
Breaking a link to a symbol	393
Replacing symbols	395
Working with Creative Cloud libraries	397
Adding assets to a Creative Cloud library	397
Using library assets	400
Updating a library asset	401
Working with global editing	403

15 PLACING AND WORKING WITH IMAGES 406

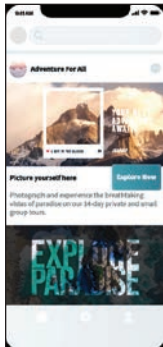

Starting the lesson	408
Combining artwork	409
Placing image files	409
Placing an image	410
Transforming a placed image	411
Cropping an image	412
Placing a Photoshop document	414
Placing multiple images	417
Masking images	419

Applying a simple mask to an image	419
Editing a clipping path (mask)	420
Masking with a shape	421
Masking an object with text	422
Finishing the masked text	424
Creating an opacity mask	424
Editing an opacity mask	425
Working with image links	428
Finding link information	428
Embedding and unembedding images	429
Replacing an image	430

16 SHARING PROJECTS 432

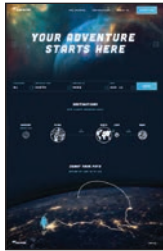

Starting the lesson	434
Fixing the missing image link	435
Packaging a file	436
Creating a PDF	437
Creating pixel-perfect drawings	438
Previewing artwork in Pixel Preview	438
Aligning new artwork to the pixel grid	439
Aligning existing artwork to the pixel grid	440
Exporting artboards and assets	442
Exporting artboards	442
Exporting assets	444

INDEX 448

Contributors	464
Production Notes	464

A QUICK TOUR OF ADOBE ILLUSTRATOR (2022 RELEASE)

Lesson overview

In this interactive demonstration of Adobe Illustrator (2022 release) you'll get an overview of the main features of the application.



This lesson will take about 45 minutes to complete. To get the lesson files used in this chapter, download them from the web page for this book at adobepress.com/IllustratorCIB2022. For more information, see “Accessing the lesson files and Web Edition” in the Getting Started section at the beginning of this book.



Begin to get comfortable with some of the essential features of Adobe Illustrator as you create an advertisement.

Starting the lesson

For the first lesson of this book, you'll get a quick tour of the most widely used tools and features in Adobe Illustrator, offering a sense of the many possibilities. Along the way, you'll create artwork for an art supply advertisement. First, you'll open the final artwork to see what you will create in this lesson.

● **Note:** If you have not already downloaded the project files for this lesson to your computer from your Account page, make sure to do so now. See the “Getting Started” section at the beginning of the book.

● **Note:** If finding the preferences file proves difficult, contact brian@brianwoodtraining.com for assistance.

- 1 To ensure that the tools and panels function exactly as described in this lesson, delete or deactivate (by renaming) the Adobe Illustrator preferences file. See “Restoring default preferences” in the “Getting Started” section at the beginning of the book.
- 2 Start Adobe Illustrator.
- 3 Choose File > Open, or click Open in the Home screen that is showing. Open the L00_end.ai file in the Lessons > Lesson00 folder.
- 4 Choose View > Fit Artboard In Window to see an example of the art supply ad you'll create in this lesson. Leave the file open for reference, if you'd like.



Creating a new document

In Illustrator, you can start a new document using a series of preset options, depending on your needs. In this case, you will save the ad you create for social media, so you will choose a preset from the Web presets to start.

- 1 Choose File > New.
- 2 In the New Document dialog box, select the Web preset category at the top of the dialog box.

You could choose from a blank document preset size to start, but in this case, you'll make the ad a specific size. In the Preset Details area on the right, change the following:

- Enter a name for the document in the blank space under “Preset Details”:
SocialMedia_ad
- Width: Select the Width value, and type **1080** (pixels).
- Height: Select the Height value, and type **1080** (pixels).

- 3 Click Create, and a new, blank document opens.

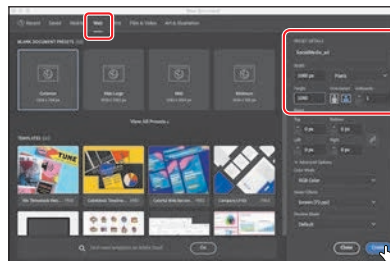

- 4 Choose File > Save As.
- 5 If the Cloud Document dialog box opens, click Save On Your Computer to save the file on your computer (locally).

Note: Learn more about what a cloud document is in Lesson 1, “Getting to Know the Work Area.”

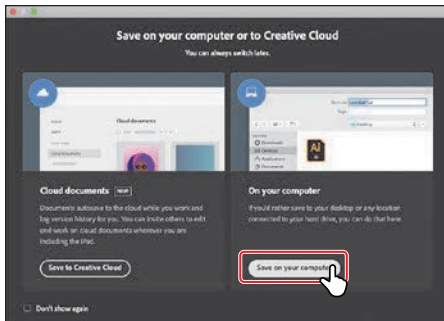

- 6 In the Save As dialog box set the following options:
 - Leave the name as SocialMedia_ad.ai.
 - Navigate to the Lessons > Lesson00 folder.
 - Leave Adobe Illustrator (ai) chosen from the Format menu (macOS) or Adobe Illustrator (*.AI) chosen from the Save As Type menu (Windows).
 - Click Save.

Note: The figures in this lesson were taken using macOS and may look slightly different from what you see if you are using Windows.

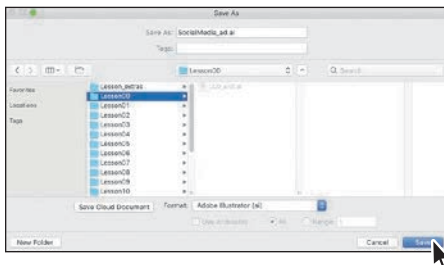

- 7 In the Illustrator Options dialog box that appears, leave the Illustrator options at their default settings, and then click OK.
- 8 Choose Window > Workspace > Essentials, and then choose Window > Workspace > Reset Essentials to reset the workspace.
- 9 Choose View > Fit Artboard In Window.

The white area you see is called the *artboard*, and it’s where your artwork will go. Artboards are like pages in Adobe InDesign or physical papers on a desk. Your document can have multiple artboards, and each can be a different size.

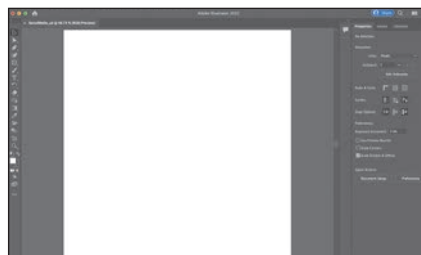

Drawing shapes

● **Note:** Explore how to make and edit all kinds of different shapes in Lesson 3, “Using Shapes to Create Artwork for a Postcard.”

Shapes are the cornerstone of Illustrator, and you’ll create many of them in the coming lessons. To start your project, you’ll make several shapes that will become a marker in the ad.

- 1 Select the Rectangle tool (▭) in the toolbar on the left.
- 2 Move the pointer into the top center of the artboard, and drag to make a small rectangle that will become the marker tip. As you drag, you’ll probably see a gray measurement label showing the size of the shape. That is a part of Smart Guides, which are turned on by default. When the gray measurement label next to the pointer shows a width of around 80 pixels and height of approximately 110 pixels, release the mouse button.

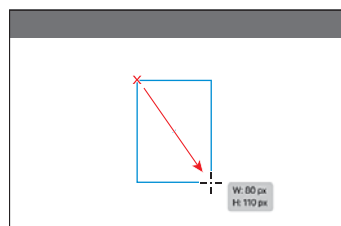
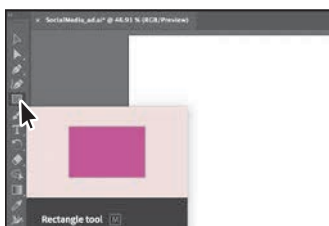

Now you’ll make a copy of the rectangle below it, to make the top part of the body of the marker.

- 3 Choose Edit > Copy, and then choose Edit > Paste In Place to paste a copy on top of it.
- 4 To move it down, drag the rectangle by the solid blue dot in the center. You’ll see a vertical magenta alignment guide as you drag, telling you the copy is aligned with the original. See the figure for how far to drag.

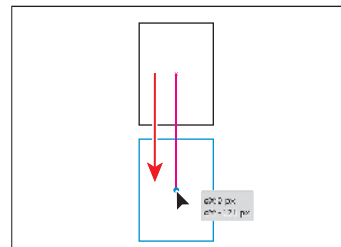

- 5 Below the new rectangle, drag to make a much larger rectangle.
For a reference, the rectangle I made is 280 pixels wide and about 600 pixels tall. See the figure for approximately how big.
- 6 Press and hold on the Rectangle tool to see a menu of tools. Select the Ellipse tool from that menu.

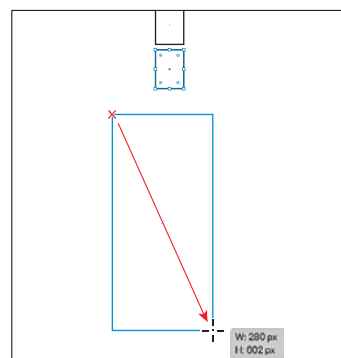

- 7 Press the Shift key and drag to make a perfect circle that fits within the largest rectangle. Release the mouse button and then the key.

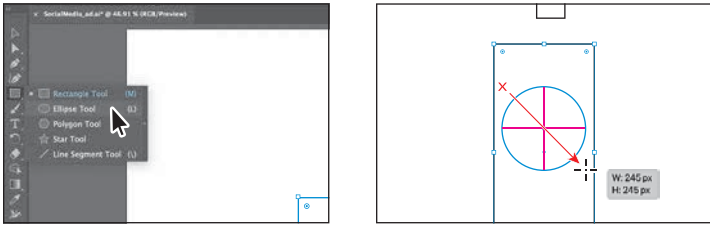

Editing shapes

Most shapes are *live*, which means you can edit them without switching away from the tool you're drawing with. Next you'll edit the circle, and then the larger rectangle. The edits you will make will be more exacting.

- 1 With the circle still selected, drag it from the blue dot in the center so the left edge aligns (snaps) to the left edge of the larger rectangle.

A vertical magenta guide will show when the circle is aligned with the rectangle.

- 2 To make the circle as wide as the rectangle, pressing the Shift key, drag the point on the right side of the box around the circle, to the right. When the pointer snaps to the right edge of the rectangle, release the mouse button and then the key.

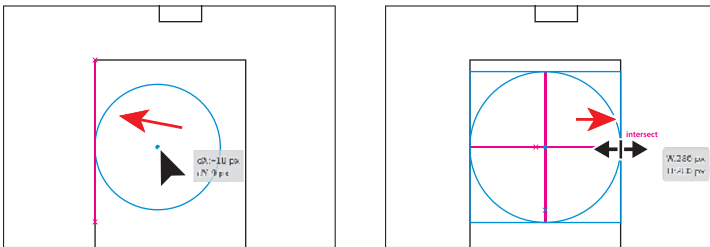

- 3 With the circle still selected, drag it up from the blue dot in the center so the center of the circle aligns (snaps) with the top of the larger rectangle.

Magenta guides will show when the circle is aligned with the rectangle.

- 4 Select the Selection tool (V) in the toolbar on the left to edit the other shapes.

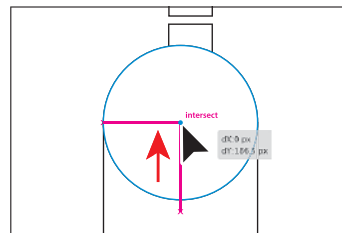

Note: Learn more about editing shapes in Lesson 3, and Lesson 4, "Editing and Combining Shapes and Paths."

- 5 Click in the largest rectangle to select it. Drag the bottom middle point on the box down to make the rectangle taller until you see a height of about 670 pixels in the gray measurement label next to the pointer.
- 6 To move the two smaller rectangles in place, click one of the rectangles, and then Shift-click the other.
- 7 Drag them onto the circle, making sure they are centered on the circle. A vertical magenta guide will show when it is. Use the figure as a reference.
- 8 Choose File > Save to save the document.

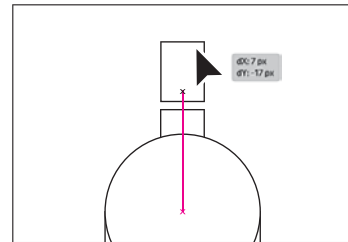
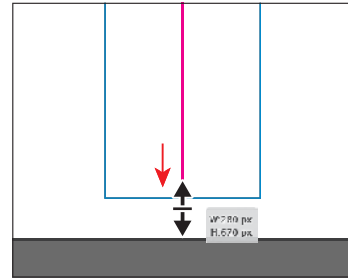

Combine shapes using the Shape Builder tool

Note: Learn more about working with the Shape Builder tool in Lesson 4.

The Shape Builder tool () is used to create more complex shapes by merging and removing simpler shapes. Next you'll merge the circle, larger rectangle, and one of the smaller rectangles to make the body of the marker.

- 1 Starting in an empty area of the artboard, drag across the three shapes to select them.
- 2 Select the Shape Builder tool () in the toolbar on the left.
- 3 Move the pointer to roughly where you see the pointer in the first part of the following figure. Drag through all of the shapes to combine them, following the second part of the figure for where to drag. Release the mouse button, and the shapes are combined.

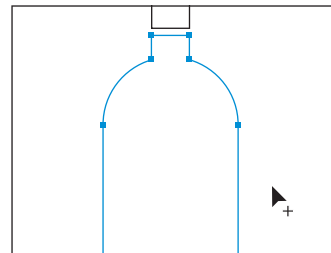
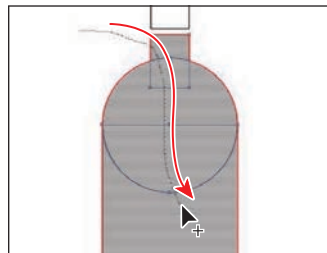
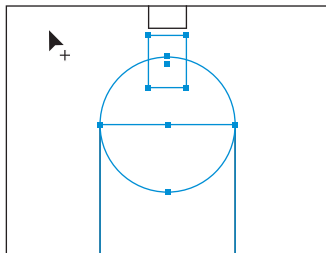
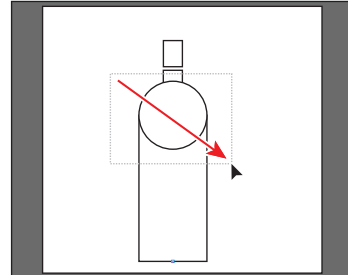

Now you'll round a few of the corners on the bottle. To round only a few, you need to select certain anchor points using the Direct Selection tool.

The blue squares on the selected shape are called *anchor points*. They are used to control the path's shape.

- 4 Select the Direct Selection tool (⬮) in the toolbar.

You will also see a bunch of double circles called *corner radius widgets*. They control the roundness of the corners. To round two corners at once, you will select the anchor points on just those corners.

- 5 Drag across the two anchor points you see in the following figure.
- 6 Drag either double-circle away from the shape to round the corners as much as you want.

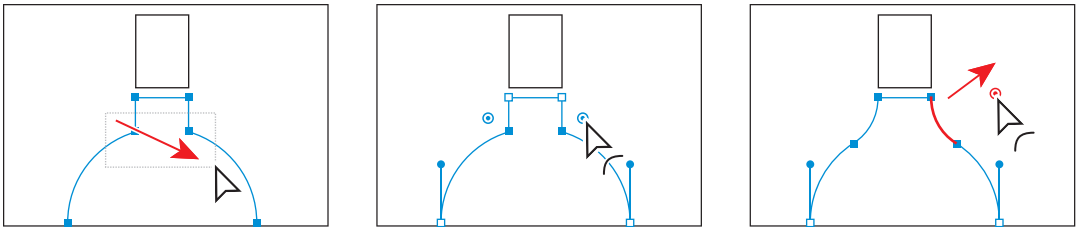

If you drag far enough, the paths will turn red, telling you that's as much as you can round the corners.

- 7 Save the file by choosing File > Save.

Applying and editing color

Applying color to artwork is a great way to express yourself creatively. Shapes you create can have a stroke (border) that goes around the edge and can be filled with a color. You can apply and edit swatches, which are saved colors that you make or that come with each document by default.

- 1 Select the Selection tool (⬮) in the toolbar.
- 2 Click the small marker tip rectangle to select it.
- 3 Click the white color box (□) to the left of the word "Fill" in the Properties panel. In the Swatches panel that opens, ensure that the Swatches option (☑) is selected at the top. Move the pointer over the color swatches, and a tool tip appears, telling you the name of the swatch. Click an orange color with the tool tip ("R=247, G=147, B=30") to change the fill color.

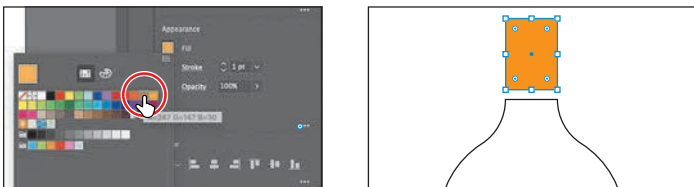

● **Note:** Learn more about paths and anchor points in Lesson 7, "Drawing with the Pen tool."

● **Note:** Learn more about fill and stroke in Lesson 8, "Using Color to Enhance Artwork."

While you can use the default swatches, you can also create your own colors and save them as swatches to reuse later.

● **Note:** Going forward, you'll find you need to hide panels such as the Swatches panel before you continue. You can press the Escape key to do this.

- 4 To remove the stroke (border) on the shape, in the Properties panel, click the down arrow for the stroke weight until it is gone.
- 5 Select the marker body shape to change its fill color as well.
- 6 Click the Fill color box (□) to the left of the word "Fill" in the Properties panel. In the Swatches panel, click to apply a lighter orange color to the marker tip. Leave the Swatches panel showing. Now you'll edit that color.

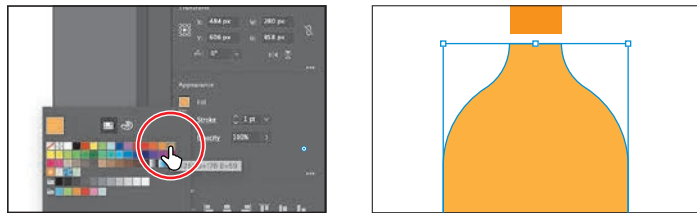
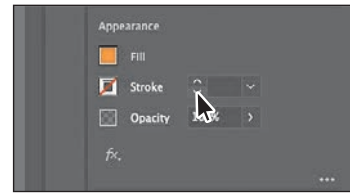

- 7 Double-click the swatch you applied in the Swatches panel (it has a white border around it).
- 8 In the Swatch Options dialog box, select Preview to see the change to the marker body. Drag the G (Green) slider to the right to give the color some more yellow and make it a bit lighter. The swatch is made of red, green, and blue colors.
- 9 Click OK to save the change you made to the swatch.

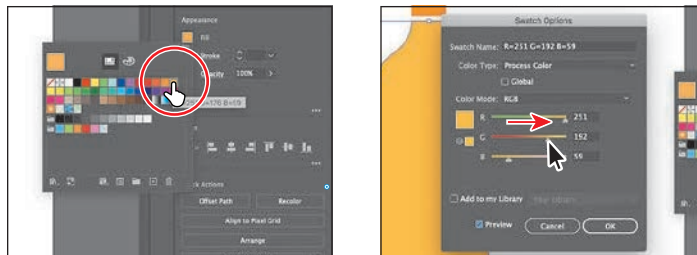

- 10 To remove the stroke (border) on the shape, in the Properties panel, click the down arrow for the stroke weight until it is gone.

Transforming artwork

From rotating and scaling to moving, shearing, and reflecting, transforming artwork in Illustrator will allow you to create unique and creative projects.

Now you'll reshape the marker tip, and then make some copies of the whole marker, change the color, and rotate them.

- 1 Click the small marker tip rectangle to select it.
- 2 Select the Direct Selection tool () in the toolbar and click the upper-left corner point on the shape to select it. Release the mouse button, and then drag that selected corner point down to give the marker tip a chiseled look.

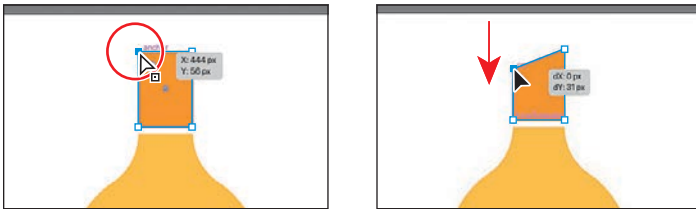

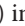
- 3 Select the Selection tool () in the toolbar.
- 4 To deselect everything, choose **Select > Deselect**.
- 5 To select both shapes on the artboard, choose **Select > All On Active Artboard**.

- 6 Click the **Group** button toward the bottom of the Properties panel on the right.

Grouping treats the selected objects as one. The next time you want to select both the marker tip and the body you can simply click one to select them as a group.

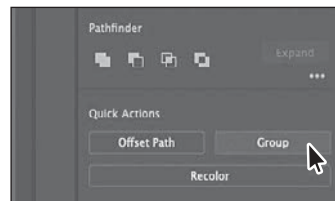

Note: If your marker is not in the middle of the artboard, go ahead and drag it into the middle.

- 7 Choose **Edit > Copy** and then **Edit > Paste** to make a copy.
- 8 Drag the copy to the left, as in the figure.

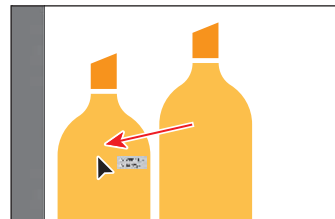

- 9 To rotate the copy of the marker, move the pointer just off a corner of the box around it. When you see curved arrows, drag counter clockwise to rotate it a little.

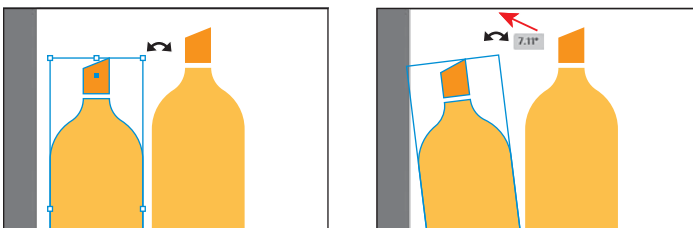

With one marker copy in place, you'll make another copy and flip it so it's on the other side of the original marker.

- 10 With the marker still selected, make a copy by choosing Edit > Copy. This time, choose Edit > Paste In Place to make a copy right on top of the original.
- 11 To flip the copy, in the Properties panel, click the Flip Horizontally button (↔).
- 12 Press the Shift key, and drag the marker to the right of the marker in the middle. Release the mouse button and then the key. Leave the marker selected.

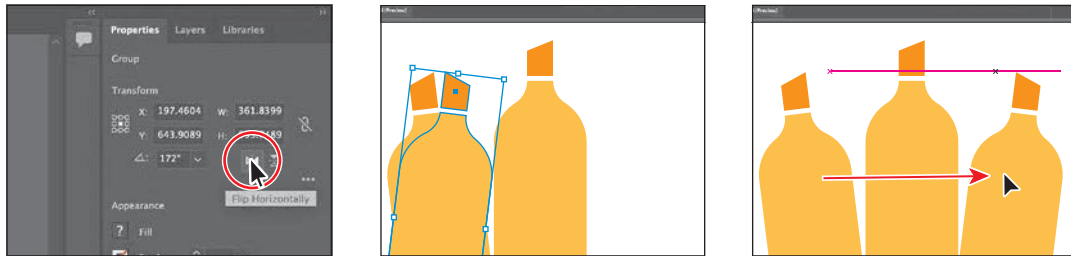

Recoloring artwork

In Illustrator, you can easily recolor artwork using the Recolor Artwork option. Next, you'll recolor the two marker copies.

- 1 Shift-click the marker on the far left to select both.
- 2 Click the Recolor button toward the bottom of the Properties panel to open the Recolor Artwork dialog box.

● **Note:** If you click anywhere in the document, the Recolor Artwork dialog box will close. To open it again, make sure the markers are selected, and then click the Recolor button in the Properties panel.

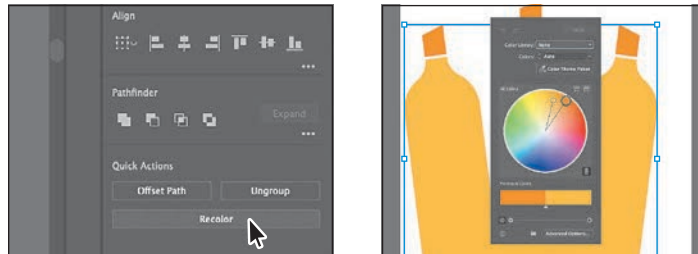

You can see the two colors from the bottle—the orange and lighter orange, as circles on the color wheel in the middle of the dialog box. Recolor artwork lets you change color in selected artwork. Now, you'll show the swatches that are in the document and then change the two orange colors.

- 3 Choose Document Swatches from the Color Library menu at the top of the panel.

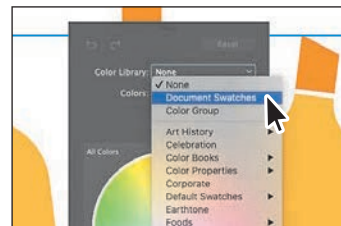

The color wheel now shows the swatches you saw when editing the fill color of artwork in the Properties panel. You can drag the little color circles in the color wheel to change the corresponding color in the selected art. But, by default, dragging one color circle drags all together.

- 4 To edit the two colors independently, click the link icon (🔗) beneath the color wheel to turn it off. It will look like this after you click it: 🔗. It's circled in the first part of the following figure.
- 5 Now, drag each of the orange circles, one at a time, into a different red color to change the artwork.

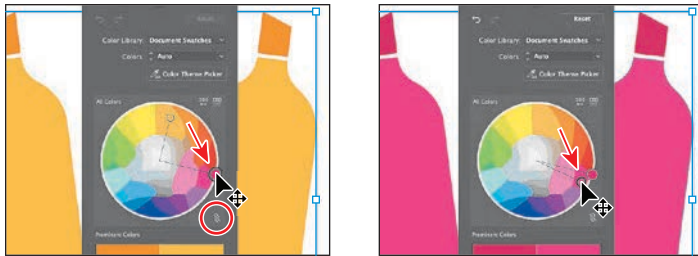

- 6 Click in an empty area of the document window to hide the Recolor Artwork dialog box.
- 7 To select all of the markers, choose Select > All On Active Artboard.
- 8 Choose Object > Group to group them all together.
If you need to edit one of the markers, you can always click the Ungroup button in the Properties panel to break the markers apart again.
- 9 Choose Select > Deselect.
- 10 Choose File > Save.

Creating and editing a gradient

Gradients are two or more colors that gradually blend one into another over a distance that you can apply to the fill or stroke of artwork. Next, you'll up your color game and apply a gradient to a banner. Then you will add some text to it.

- 1 Choose View > Zoom Out so it's easier to see the edges of the artboard.
- 2 Press and hold the mouse button on the Ellipse tool (○) in the toolbar, and select the Rectangle tool (□) from the menu of tools.

● **Note:** Learn more about working with gradients in Lesson 11, "Gradients, Blends, and Patterns."

3 Starting on the left edge of the artboard, drag across to the right edge, making a rectangle the width of the artboard and with a height of approximately 375 pixels.

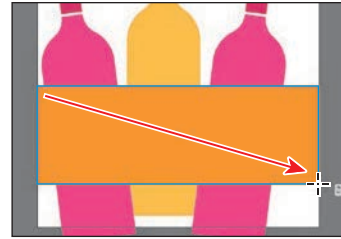

4 In the Properties panel, click the Fill color box, and select the white-to-black swatch with the tool tip “White, Black.” Leave the Swatches panel showing.

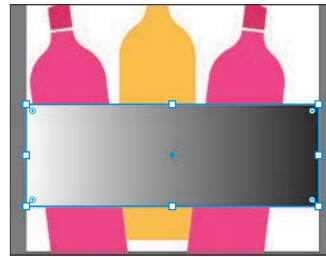
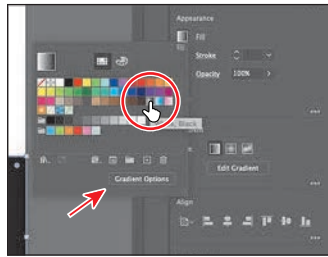

5 At the bottom of the Swatches panel, click the Gradient Options button to open the Gradient panel. An arrow is pointing to the button in the previous figure. You can drag the Gradient panel by the title bar at the top to move it around.

6 In the Gradient panel, do the following:

- Click the Fill box to make sure you are editing the fill (circled in the figure).
- Double-click the little black color stop (📍) on the right side of the gradient slider in the Gradient panel (an arrow is pointing to it in the figure).
- Click the Swatches button (📄) in the panel that appears. Select a dark blue swatch.
- Double-click the little white color stop (📍) on the left side of the gradient slider in the Gradient panel (an arrow is pointing to it in the figure).
- Select a lighter blue swatch.

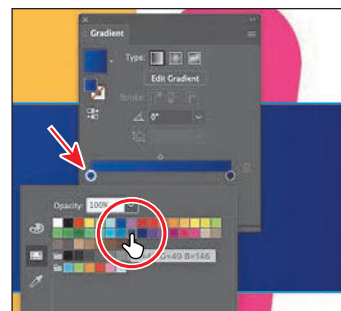
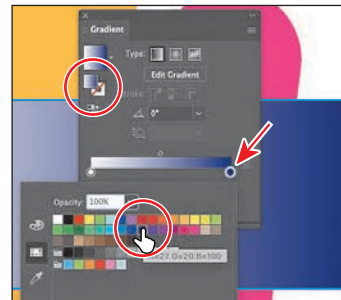

There are a lot of creative possibilities with gradients, from applying gradients to the stroke (border) of objects to making color transparent (see-through).

7 Click the X at the top of the Gradient panel to close it.

Editing strokes

A *stroke* is the outline (border) of artwork such as shapes and paths. There are a lot of appearance properties you can change for a stroke, including width, color, dashes, and more. In this section, you'll adjust the stroke of the banner rectangle.

● **Note:** Learn more about working with strokes in Lesson 3.

- 1 With the rectangle still selected, click the word “Stroke” in the Properties panel.

In the Properties panel, when you click an underlined word, more options appear in a panel.

- 2 In the Stroke panel, change the following options:

- Stroke Weight: **11 pt**
- Click Align Stroke To Inside () to align the stroke to the inside of the rectangle edge.

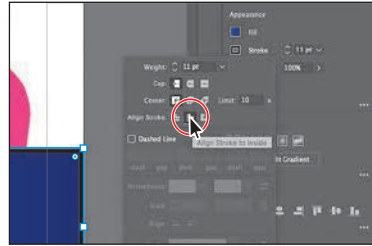

- 3 In the Properties panel, click the Stroke color box () and select the white swatch.

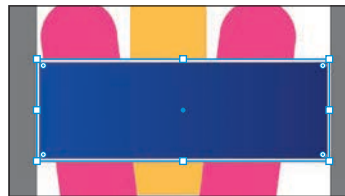
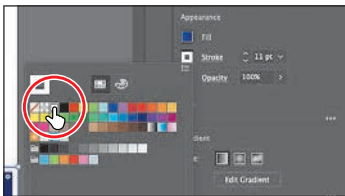





- 4 Choose Select > Deselect.

Creating with the Curvature tool

With the Curvature tool () you can draw and edit smooth, refined paths and also straight lines. In this section, you'll explore the Curvature tool while creating a marker scribble.

● **Note:** Learn more about working with the Curvature tool in Lesson 6, “Using the Basic Drawing tools.”

- 1 Select the Curvature tool () in the toolbar. Before you start drawing, you'll remove the fill and change the stroke color.
- 2 Click the Fill color box () to the left of the word “Fill” in the Properties panel. In the Swatches panel, click to apply the None () swatch to remove the fill.
- 3 Click the Stroke color box () to the left of the word “Stroke” in the Properties panel. In the Swatches panel, click to apply an orange swatch.

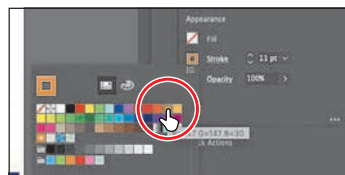
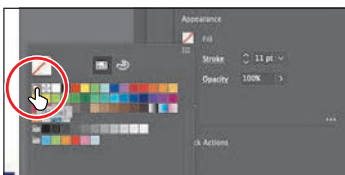

● **Note:** If the pointers you see don't match the figures, make sure Caps Lock is not on.

- 4 Move the pointer into the middle of the marker tip (see the first part of the following figure). Click and release to start drawing a shape.
- 5 To make a serpentine shape (like an "s"), move the pointer to the left, and click and release (see the second part of the figure). Move the pointer away after clicking to see a curving path.



Every time you click, you are creating what is called an *anchor point*. As described earlier, anchor points you add (the circles you see on the path) control the shape of the path.

► **Tip:** After creating the path, you can move the pointer over any of the anchor points on the path—the circles—and drag to edit the path.

- 6 Make a scribble by clicking to the right, to the left, and then to the right. See the figure for where I clicked.
- 7 Press the Esc key to stop drawing.

With the path selected, next you'll change the order of the artwork and put the path behind everything else on the artboard.



- 8 Click the Arrange button in the Quick Actions section of the Properties panel. Choose Send To Back to stack it behind everything. Leave it selected.

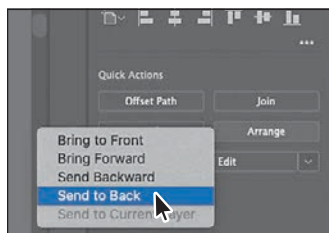

Applying a brush

● **Note:** Learn more about getting creative with brushes in Lesson 12, "Using Brushes to Create an Ad."

With brushes, you can decorate paths with patterns, figures, brush strokes, textures, or angled strokes. You can also modify the brushes provided with Illustrator and create your brushes. Next, you'll apply a brush to the path you just drew to make it look more like a marker scribble.

- 1 Select the Selection tool (▸) in the toolbar.
- 2 With the path you drew still selected, choose Window > Brush Libraries > Artistic > Artistic_Ink. It's toward the bottom of the long menu that displays.

- 3 Scroll in the Artistic_Ink panel, and click the brush named “Marker” to apply it.

In the panel that opens, you see some brushes that come with Illustrator.



- 4 Change the Stroke Weight in the Properties panel to 6 pt by clicking the up arrow to the right of the word “Stroke.”

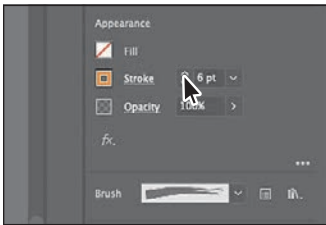

- 5 Close the Brushes panel by clicking the X in the top corner of the panel.
- 6 Choose File > Save.

Working with type

Next you’ll add text to the project and make some formatting changes to it.

- 1 Select the Type tool (**T**) in the toolbar on the left, and click in the large rectangle with the gradient fill. Placeholder text will appear with the selected placeholder text, “Lorem ipsum.”
- 2 Type **ART SUPPLIES** in capital letters. The text will be small and hard to read against the gradient. You’ll remedy that next.
- 3 Select the Selection tool (**☛**) so the text object is selected.
- 4 Click the Fill color box (■) in the Properties panel. In the Swatches panel, click to apply an orange color.

● **Note:** Learn more about working with type in Lesson 9, “Adding Type to a Project.”

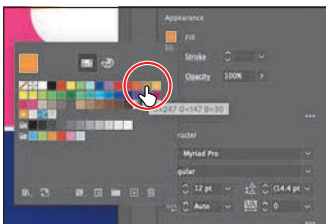
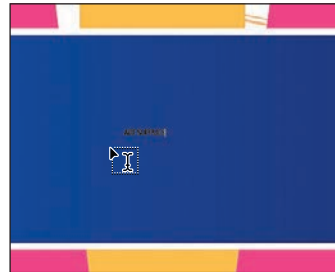

- 5 In the Character section of the Properties panel, select the font size, and type **73**. Press Return or Enter to accept the size change.
- 6 In the same section of the Properties panel, change the Tracking (**VA**) value by selecting the value in the field and typing **30** (highlighted in the following figure). Press Return or Enter to accept the change. Tracking is how you can adjust spacing between characters. Leave the text selected.



Warping text

● **Note:** Learn more about warping text in Lesson 9.

You can create some great design effects by warping text into different shapes using envelopes. You can make an envelope out of an object on your artboard, or you can use a preset warp shape or a mesh grid as an envelope.

- 1 With the Selection tool selected and the text still selected, copy and paste the text by choosing Edit > Copy and then Edit > Paste.
- 2 Drag the two text boxes so they are still within the bounds of the rectangle and stacked one on top of the other.
- 3 Select the Type tool, move the pointer over the top text, and triple-click to select it. Type **CRAFTY**.
- 4 Select the Selection tool (▶) so the **CRAFTY** text object is selected.
- 5 Change the font size to **190** in the Properties panel on the right.



6 Choose Object > Envelope Distort > Make With Warp to open the Warp Options dialog box. In that dialog box, change the following:

- Style: Arch (*not Arc*)
- Bend: 20%



7 Click OK. The text is now in a shape, but is still editable.

8 With the Selection tool selected, drag the curved text and the “ART SUPPLIES” text into position.

9 Choose Select > Deselect.



► **Tip:** To edit the warp options again in the Warp Options dialog box, click the Warp Options button in the Quick Actions section of the Properties panel.

Working with effects

Effects alter the appearance of an object without changing the base object. Next you'll apply an effect to a sale sticker you make.

1 Press and hold on the Rectangle tool (□) in the toolbar, and select the Ellipse tool (○). Over the top of the banner rectangle, Shift-drag to make a circle like the one in the figure. Release the mouse button and then the key.

2 Click the Fill color in the Properties panel. In the panel that opens, select a color. I chose a light blue.



● **Note:** Learn more about effects in Lesson 13, “Exploring Creative Uses of Effects and Graphic Styles.”



- 3 In the Properties panel, click the Choose An Effect button (fx), and choose Distort & Transform > Zig Zag.
- 4 In the Zig Zag dialog box, select Preview to see your changes, if it isn't already selected, and then set the following options:
 - Size: **9 px**
 - Absolute: Selected
 - Ridges Per Segment: **9**
 - Points: Corner

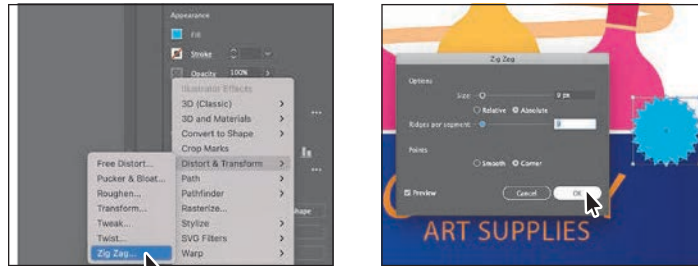

- 5 Click OK.

Adding more text for practice

Now for a little practice! Try adding some text on top of the circle. You'll apply formatting you've already learned and a few more options. Here are the steps:

- 1 Select the Type tool (T), and click to add some text. To replace the text, type **30%**, press Enter or Return, and then type **OFF**.
- 2 Select the Selection tool (black arrow) so the text object is selected.
- 3 Set the following options in the Properties panel:
 - Change the fill color to white.
 - Change the font size to **60 pt**.
 - Change the Leading (circled in the figure) to **50**. This changes the distance between the lines of text.
 - In the Paragraph section of the Properties panel (below the formatting options you just set), click Align Center (≡) so the text is center aligned.

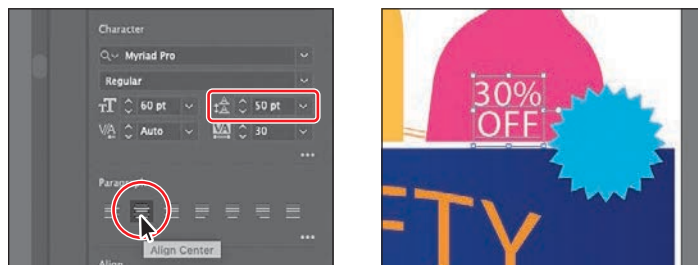

- 4 Drag the text so it is approximately centered on the circle.
- 5 Shift-click the blue circle to select the text and the blue circle.
- 6 Click the Group button in the Quick Actions section of the Properties panel to keep them together as a group.

Note: If your circle is too small, press the Shift key and drag a corner to make it larger. Release the mouse button and then the key.

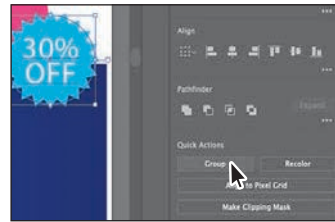

Aligning artwork

Illustrator makes it easy to align or distribute multiple objects relative to each other, the artboard, or a key object. In this section, you'll move artwork into position and align some of it to the center of the artboard.

Note: Learn more about aligning artwork in Lesson 2, "Techniques for Selecting Artwork."

- 1 With the Selection tool (⬚) selected, click to select the group of markers.
- 2 To select more content, press the Shift key, and click the banner rectangle, the "CRAFTY" text, and the "ART SUPPLIES" text.
- 3 Click the Align To Selection menu (⌘) in the Properties panel to the right of the document, and choose Align To Artboard from the menu. Any content you apply an alignment to will now align to the edges of the artboard.

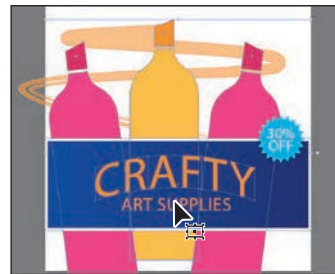

- 4 Click the Horizontal Align Center button (⌘) to align the selected artwork to the horizontal center of the artboard.

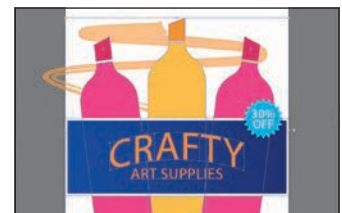
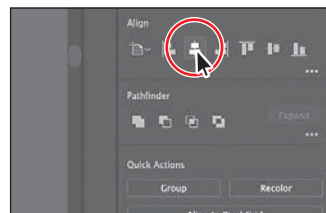
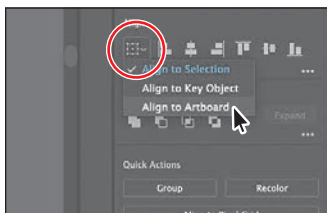

- 5 If necessary, drag the marker scribble and the sale bug into position.
- 6 Choose File > Save, and then choose File > Close.

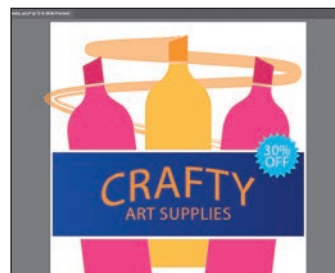

INDEX

NUMBERS

3D and Materials panel, 6, 376

3D effects, 6, 376, 377

A

Adobe Add-ons, 5

Adobe Authorized Training Partners, 5

Adobe community resources, 5

Adobe fonts, 7, 250–253

Adobe Illustrator. *See* Illustrator

Align to Pixel Grid button, 440, 441, 442

aligning

 anchor points, 73

 artboards, 146–147

 artwork, 27, 439–442

 objects, 70–75

 to pixel grid, 439–442

 strokes, 21, 97

 text, 259

alignment guides, 12, 63, 98, 191

Anchor Point tool, 207–208

anchor points

 adding, 22, 205, 206

 aligning, 73

 converting, 195–197, 206–208

 deleting, 204–205

 editing, 204–206

 explained, 63

 key, 73, 206

 selecting, 63–64, 189

 shapes and, 87

 size adjustment, 64

 smooth vs. corner, 173

 undoing, 199

Android export options, 445

AppData folder (Windows), 4

appearance attributes, 360–368

 adding multiple, 362–363, 364

 applying to layers, 294

 copying, 226–227

 deleting, 362, 380

 description of, 360

 editing, 361–362

 graphic styles as, 376

 reordering, 367–368

 text with, 364–367

 viewing hidden, 362

Appearance panel, 360–368

 attributes edited in, 361–362

 effects edited in, 370, 383

 formatting options in, 367

 multiple attributes added in, 362–367

 overview of options in, 360

 patterns applied in, 322–323

 reordering attribute rows in, 367–368

Application bar, 33

Application frame options, 55

area type

 adding to documents, 244–245

 Auto Sizing feature, 246

 converting point type to, 246

 setting options for, 260

 vertically aligning, 259

arranging

 artboards, 147

 documents, 55–56

 layer content, 286

 objects, 79–80

arrowheads on paths, 182

Art brushes, 339–343, 355

 applying existing, 339–340

- creating from existing artwork, 340–341
- editing options for, 341–343
- Artboard Editing mode, 141, 142, 143–145, 147, 165
- Artboard Options dialog box, 148, 165
- Artboard tool, 141, 143, 144, 145, 146
- artboards, 141–149
 - adding to documents, 141–142
 - aligning content to, 74–75
 - arranging and aligning, 146–147
 - copying between documents, 145–146
 - creating new, 142–143
 - deleting, 144–145
 - editing, 143–145
 - explained, 11, 31
 - exporting, 442–443, 447
 - fitting in window, 31
 - navigating, 51–53, 57
 - options for, 148, 149
 - renaming, 148
 - reordering, 148–149
 - resizing, 144, 165
 - rulers for, 150, 165
- Artboards panel, 43, 148–149
- artwork
 - aligning, 27, 439–442
 - Art brush created from, 340–341
 - combining vector and raster, 409
 - creating with Pen tool, 199–203
 - editing colors in, 16, 231–233
 - erasing parts of, 122–123
 - file formats for exporting, 442
 - fills added to, 362–363
 - flattening, 296
 - gradient applied to, 309
 - grid behind, 92
 - placing, 107
 - positioning, 153
 - recoloring, 18–19, 231–233
 - rotating, 155
 - scaling, 154–155, 156
 - tracing, 103–105
 - transforming, 17–18, 152–158
 - viewing, 46–51
 - warping, 161–164
 - See also* objects

- aspect ratio of gradients, 311
- Asset Export panel, 444–446, 447
- assets
 - CC library, 397–402
 - exporting, 444–446, 447
- attribute rows
 - deleting, 362
 - reordering, 367–368
 - See also* appearance attributes
- Auto Sizing feature, 246

B

- bitmap images, 30
- bleed area, 86
- blend objects, 317, 318
- Blend Options dialog box, 318, 320
- Blend tool, 318, 320
- blends, 317–321
 - creating, 318
 - examples of, 317
 - modifying, 319
 - smooth color, 320–321
 - spine of, 319
 - See also* gradients
- Blob Brush tool, 352–354, 355
 - drawing with, 352–353
 - Eraser tool used with, 354
 - sizing/resizing, 353
- bounding box, 62, 152–153
- brightness adjustment, 46
- Bristle brushes, 350–352
 - changing options for, 350
 - grouping paths made with, 352
 - painting with, 351
- brushes, 328–355
 - applying, 22–23
 - Art, 339–343
 - Blob Brush tool, 352–354
 - Bristle, 350–352
 - Calligraphic, 331–338
 - creating new, 340–341, 345–347
 - editing, 333–334, 341–343, 348–349, 350
 - libraries of, 334–335, 344, 350

- brushes (*continued*)
 - Paintbrush tool, 331, 334–337
 - Pattern, 344–349
 - previewing changes to, 334
 - removing strokes made by, 338
 - size setting for, 350, 353
 - types of, 331
- Brushes panel, 331, 333, 338
- bullet character, 246
- C**
- Calligraphic brushes, 331–338
 - applying to artwork, 332–333
 - editing options for, 333–334
 - Paintbrush tool and, 334–337
 - removing strokes made by, 338
- canvas, rotating, 54
- Caps Lock key
 - Join tool and, 181
 - Knife tool and, 119, 121
 - Pen tool and, 188
 - Pencil tool and, 177
- cascading documents, 55
- center point widget, 87
- Character panel, 256
- character styles, 262, 273
 - creating and applying, 265–267
 - editing, 267
- Character Styles panel, 266–267
- characters
 - formatting applied to, 256–257
 - styles applied to, 262, 265–267
- circles, creating/editing, 13, 94–96
- Classroom in a Book training series, 1
- Clear Filter button, 253
- clip groups, 108, 420
- clipping masks
 - applying to images, 419
 - creating, 295–296, 297
 - editing, 420–421
 - explained, 295, 419
 - releasing, 296
 - See also* masks
- clipping paths, 108, 419, 420–421
- clipping set, 419
- closed paths, 87
- Cloud Document dialog box, 11, 32, 437
- cloud documents, 7, 32, 418
- cloud icon, 428
- CMYK color mode, 213, 214, 226
- Collect in New Layer option, 295
- color groups, 227–228
- Color Guide panel, 228–230
 - applying colors from, 230
 - using for inspiration, 228–229
- color harmonies, 229, 232, 239
- color markers, 232–233
- Color Mixer panel, 215
- color modes, 213, 438
- Color panel, 215
- Color Picker, 221–223
- color stops, 301
 - freeform gradient, 314–315
 - Lines mode for applying, 316–317
 - radial gradient, 310
 - stroke gradient, 307–308
- color swatches, 216–221
 - applying colors with, 15–16
 - creating copies of, 217–218
 - editing, 16, 218–221
 - global, 216, 218–219, 220, 239
 - libraries of, 223, 224
 - non-global, 219–221
 - saving colors as, 216–217, 223, 239
 - spot-color, 224
- Color Theme Picker, 233
- colors, 214–234
 - applying, 15–16, 214, 230
 - blending, 320–321
 - Color Picker for, 221–223
 - converting between modes, 226
 - copying with Eyedropper, 226–227
 - creating custom, 215
 - editing, 16, 18–19, 231–233
 - gradient, 307–308, 310
 - grouping, 227–228

- guidance for choosing, 228–229
- layer, 279, 297
- naming, 216
- sampling, 233–234
- spot, 223, 224–225
- swatches for, 216–221
- text or type, 255
- tints of, 225–226, 239

columns, text, 260

combining shapes, 126–132

- Pathfinder effects for, 130–132
- Shape Builder tool for, 127–129

Comments panel, 6

compound paths, 124–125

constraining handles, 201

Content Aware feature, 412

context-sensitive menus, 45

Control panel, 43, 439

converting

- anchor points, 180, 195–197, 206–208
- colors between modes, 226
- point type to area type, 246

convert-point icon, 196, 198, 201, 202

copying

- appearance attributes, 226–227
- artboards between documents, 145–146

corner points, 173, 188

- converting between smooth and, 195–197, 206–208, 209
- creating with Curvature tool, 173–174
- smooth points distinguished from, 173, 209

corner radius widgets, 15

Create New Layer button, 279, 291

Create New Style button, 263, 264

Create Report option, 436

Creative Cloud desktop application, 250

Creative Cloud Libraries, 397–402

- adding assets to, 397–399
- tooggling the display in, 398
- updating assets in, 401–402
- using assets in, 400

See also libraries

cropping images, 412–414

Curvature tool, 21–22, 169–174

- creating corners with, 173–174, 183
- drawing paths with, 169–171
- editing paths with, 172–173

curves

- combining straight lines and, 197–198
- Pen tool for drawing, 192–195, 209

cutting shapes

- Knife tool for, 118–121
- Scissors tool for, 115–116

D

dashed lines, 175–176

default preferences, 4–5

Delete Selection icon, 380

deleting

- anchor points, 204–205
- appearance attributes, 362, 380
- artboards, 144–145
- preferences file, 4
- shapes, 127, 128
- width points, 134
- workspaces, 43

See also removing

deselecting paths, 194, 203

Direct Selection tool, 63–64, 65, 189, 194, 209, 420, 441

direction handles, 187, 192, 194, 200–202, 207

direction lines, 187, 192, 193, 196

direction points, 187, 192, 194

Discover panel, 7

distorting artwork, 161

distributing objects, 72

docking

- panels, 40–41
- toolbar, 36

Document Setup dialog box, 86

Document window, 33, 55

documents

- adding artboards to, 141–142
- arranging, 55–56

- documents (*continued*)
 - categories for, 84, 111
 - cloud, 7, 32, 418
 - copying artboards between, 145–146
 - creating, 10–11, 84–86
 - cycling between, 55
 - groups of, 55
 - panning in, 50
 - saving, 11
 - Draw Behind mode, 107, 109
 - Draw Inside mode, 107–108, 111
 - Draw Normal mode, 106, 109
 - drawing
 - Blob Brush tool for, 352–353
 - Curvature tool for, 21–22, 169–171
 - curves, 192–195, 209
 - lines, 102–103, 178–179, 187–188
 - modes for, 106–109
 - Paintbrush tool for, 334–335
 - paths, 169–171, 177–178
 - Pen tool for, 187–188, 190–195
 - Pencil tool for, 177–179
 - shapes, 12–13
 - Drop Shadow effect, 294, 369–370
 - drop zone, 36
 - duplicating
 - layer content, 291–292
 - linked files, 436
 - dX and dY measurements, 64
 - dynamic symbols, 391, 405
- E**
- Edit Artboards button, 141
 - Edit Toolbar option, 36, 37
 - editing
 - anchor points, 204–206
 - appearance attributes, 361–362
 - artboards, 143–145
 - brushes, 333–334, 341–343, 348–349, 350
 - character styles, 267
 - circles, 95–96
 - clipping masks, 420–421
 - color swatches, 16, 218–221
 - colors in artwork, 16, 18–19, 231–233
 - Curvature tool for, 172–173
 - effects, 370
 - ellipses, 93–94
 - envelope warp, 271
 - Eraser tool for, 122–123, 354
 - global, 403–404
 - gradients, 20, 302–303, 307–308
 - groups in Isolation mode, 77–78
 - inside content, 108–109
 - mirror repeats, 160–161
 - opacity masks, 425–427
 - paragraph styles, 265
 - paths, 172–173, 189–190, 204, 336–337
 - patterns, 326
 - polygons, 98–99
 - rectangles, 88–90
 - shapes, 13–14, 115–125
 - strokes, 21, 96–97
 - symbols, 390, 391
 - text, 372
 - educator resources, 5
 - Effect menu, 368, 369, 375
 - effects, 25–26, 368–376
 - 3D effects, 376
 - applying, 369–370, 372–376, 383
 - Drop Shadow effect, 294, 369–370
 - editing in Appearance panel, 370
 - Offset Path effect, 373
 - Photoshop effects, 368, 375–376
 - scaling, 154, 165, 381–382
 - targeting layers with, 294
 - temporarily disabling, 372
 - text styling with, 371
 - Transform effect, 374
 - vector vs. raster, 368
 - Warp effect, 371
 - Zig Zag effect, 26
 - Ellipse tool, 12, 25, 93, 94
 - ellipses, creating/editing, 93–94
 - embedded images, 410, 429, 431
 - endpoints, 87, 117
 - envelope warp, 270–271
 - Eraser tool

- Blob Brush tool and, 354
- erasing parts of artwork with, 122–123
- setting the size of, 354
- straight line erasures using, 123, 137

Escape key, 16, 37, 72, 133, 194

Essentials workspace, 31, 43, 44, 277

Export for Screens dialog box, 443, 444, 446, 447

exporting, 442–446, 447

- artboards, 442–443
- assets, 444–446
- file formats for, 442, 447

eye icon, 204, 285, 290, 363, 423

Eyedropper tool

- color sampling with, 233–234
- copying appearance attributes with, 226–227
- text formatting sampled with, 261–262

F

Fidelity slider, 177

files

- creating PDF, 437
- Illustrator preferences, 4–5
- importing plain-text, 247
- info about lesson, 2, 3
- opening, 31
- packaging, 436

Fill color option, 16

fills

- adding multiple, 362–363, 364
- color of, 16, 214
- gradient, 301, 302, 304–306
- text, 364–365

Filter Fonts icon, 251

Filter Gallery dialog box, 375–376

finding content, 280–282

Fit Artboard In Window view, 110

flattening artwork, 296

flipping content, 18, 136, 412

folder icon, 436, 443

fonts

- activating, 7, 140, 212, 250–252
- applying to text, 252–253
- fixing missing, 253, 276
- sizing/resizing, 254–255
- used in this book, 2
- See also* text

formatting

- sampling with Eyedropper tool, 261–262
- type or text, 250–259, 261–262

Free Transform tool, 158

freeform gradients, 301

- applying, 314–315
- editing in Points mode, 315–316

free-form paths, 169, 177

G

Global Edit, 403–404

global rulers, 150, 165

global swatches, 216, 218–219, 220, 239

glyphs

- using snapping with, 259
- video on working with, 258

Glyphs panel, 258

Go To Link button, 428, 435

GPU performance, 49

GPU Preview mode, 51, 70, 285

gradient annotator, 305, 310

Gradient panel, 20, 301, 302–303, 306, 311, 313

gradient slider, 301, 302, 305, 308, 310

Gradient tool, 301, 305–306, 310, 312–313, 314

gradients, 19–20, 301–317

- adjusting, 304–306, 310–312
- applying to multiple objects, 312–313
- artwork utilizing, 309
- aspect ratio of, 311
- color stops in, 301, 307–308, 310, 314–315, 316–317
- editing, 20, 302–303, 307–308
- explained, 301, 327
- fill, 301, 302, 304–306
- freeform, 301, 314–316

gradients (*continued*)
linear, 301, 304–306
opacity mask, 426–427
radial, 301, 309–312
resizing, 311
rotating, 305
saving, 303–304
stroke, 306–308
transparency added to, 313–314
See also blends

Grain effect, 375–376

graphic styles, 376–381
adding multiple, 381
applying, 377, 378, 381
creating new, 378
explanation of, 376
layers and, 380–381, 383
libraries of, 377
text and, 378
updating, 379–380

Graphic Styles panel, 376, 377, 378, 379, 380

grid
artwork, 92
pixel, 438, 439–442

grid repeats, 158, 161

Group Selection tool, 34, 78, 81

groups
clip, 108, 420
color, 227–228
document, 55
isolated, 77–78
Live Paint, 235–238
nested, 78–79
object, 17, 75–79, 282
panel, 39
path, 352
renaming, 282
rotating, 110
shape, 110

guides
alignment, 12, 63, 98, 191
creating, 150–151
Smart, 62, 98

H

Hand tool, 50, 141, 193, 330

handles
constraining, 201
direction, 187, 192, 194, 200–202, 207
width point, 134

harmony rules, 229

HEIF format files, 7

Help resources, 5

hiding
bounding box, 152
layers, 289–290
objects, 66–67, 81
panels, 42, 72

horizontal alignment, 27, 70, 71, 74

I

Illustrator
installing, 2
native format, 85
new features, 6–7
preferences file, 4–5
resources, 5

Illustrator Options dialog box, 11, 86, 403

Image Trace feature, 103–105

images
combining with artwork, 409
creating Art brushes from, 340–341
cropping, 412–414
embedded, 410, 429
fixing missing, 435
linked, 410, 428–430, 435
masking, 419–427
Photoshop, 414–416, 418
placing, 409–411, 414–418
replacing, 430, 431
tracing, 103–105
transforming, 411–412

importing
Photoshop images, 414–416
text, 247

installing Illustrator, 2

instances, symbol, 387, 388–389, 393–394

iOS export options, 445

Isolation mode, 77–78, 81, 108, 271, 420, 422

J

Join command, 117, 180

Join tool, 117, 180–181, 183

joining paths, 117–118, 180–181

K

key anchor points, 73, 206

key objects, 71

keyboard shortcuts

displayed in tool tips, 34

Fit Artboard in Window, 47

Hand tool, 50

Layers panel, 296

modifying on macOS, 49

resizing brushes, 353

zooming in/out, 46

Knife tool, 118–121, 137

L

layer comps, 415

Layer Options dialog box, 279

layers, 274–297

appearance attributes applied to, 294

arranging content on, 286

clipping masks for, 295–296, 297

colors for, 279, 297

creating new, 278–279

duplicating content of, 291–292

effects applied to, 294

explanation of, 277

finding content on, 280–282

flattening, 296

graphic styles applied to, 380–381, 383

hiding, 289–290

locking, 290

moving content between, 283–284

naming/renaming, 278, 279

pasting, 292–293, 297

Photoshop files with, 416

reordering, 287–288, 297

sublayers and, 280

symbol, 396

viewing, 285–286

Layers panel

eye icon, 204, 285, 290, 423

features overview, 277

finding content in, 280–282

keyboard shortcuts, 296

opening, 278

target icon, 294, 380

leading, text, 256

lesson files, 2, 3

libraries

brush, 334–335, 344, 350

graphic style, 377

swatch, 223, 224

symbol, 387, 388

See also Creative Cloud Libraries

Libraries panel, 397–399, 400, 401

Library folder (macOS), 4

Line Segment tool, 102

linear gradients, 301

adjusting, 304–306

applying to fills, 302

applying to strokes, 306

lines

creating/editing, 102–103

drawing dashed, 175–176

Pen tool for drawing, 187–188

Pencil tool for drawing, 178–179

rotating, 102, 175–176

See also straight lines

Lines mode, 316–317

Link Harmony Colors icon, 232

link icon, 19, 427, 435

linked images, 410, 428–430

embedded images vs., 410, 429, 431

finding information about, 428

fixing missing, 435

replacing, 430, 431

links

image, 410, 428–430, 435

Library asset, 401

opacity mask, 427

symbol, 387, 393–394

text, 248

- Links panel, 401, 412, 428, 429, 430, 435
- Live Corners widget, 90, 91–92, 99
- Live Paint Bucket tool, 235, 236–237
- Live Paint groups, 235–238, 239
 - creating, 235
 - modifying, 238
 - painting objects in, 236–237
- Live Shapes, 13, 88, 111
- Locate Object button, 281, 416, 419, 422
- locking
 - layers, 290
 - objects, 66
- M**
- macOS commands, 2
- magenta alignment guides, 12, 63, 98, 191
- magnification level, 46
- Make Mask button, 425
- Make Pixel Perfect option, 441
- marquee selections, 65
- Mask button, 419
- masks, 419–427, 431
 - applying to images, 419
 - editing clipping, 420–421
 - opacity, 424–427
 - shape, 421–422
 - text, 422–424
 - See also* clipping masks
- measurement label, 87, 98
- measurement units, 151, 154
- merging
 - layer content, 295
 - shapes, 14–15
 - swatches, 146
- mirror repeats, 158–161
 - applying, 158–160
 - editing, 160–161
- Missing Fonts dialog box, 140, 212, 276, 300, 358, 397
- Mop brush, 350, 351, 352
- Move dialog box, 157

- N**
- naming/renaming
 - artboards, 148
 - colors, 216
 - groups, 282
 - layers, 278, 279
- native format, 85
- Navigator panel, 50
- nested groups, 78–79
- New Artboard button, 142
- New Brush dialog box, 340, 346
- New Document dialog box, 10, 84–85
- New Swatch dialog box, 216, 217, 223
- Next artboard button, 70, 148
- non-global swatches, 219–221
- O**
- objects
 - aligning, 70–75
 - arranging, 79–80
 - blended, 317–321
 - coloring, 214
 - distributing, 72
 - gradients applied to, 312–313
 - grouping, 17, 75–79, 282
 - hiding, 66–67, 81
 - key, 71
 - locating, 281
 - locking, 66
 - painting, 235, 236–237
 - repeat, 158–161
 - rotating, 155
 - scaling, 154–155
 - selecting, 61–70
 - shearing, 156–157
 - similar, 68–69
 - stacking order of, 79, 280, 287
 - text or type, 244, 246
 - unlocking, 67–68, 147
 - See also* artwork
- Offset Path effect, 373
- online content, 2–3
- opacity
 - appearance attribute, 365

- gradient, 313
- pattern, 323
- opacity masks, 424–427
 - creating, 424–425, 431
 - disabling/enabling, 425
 - editing, 425–427
- open paths, 87, 102, 269
- ordering/reordering
 - appearance attributes, 367–368
 - artboards, 148–149
 - layers, 287–288, 297
 - objects, 79
 - symbols, 392
- Outline mode
 - selecting in, 69–70
 - viewing artwork in, 50–51, 285, 290
- outlines
 - stroke, 121, 137
 - text, 272, 273
- overflow text, 248, 273
- overset text icon, 264

P

- Package dialog box, 436
- packaging files, 436, 447
- Paintbrush tool, 331, 334–337
 - drawing with, 334–335, 355
 - editing paths with, 336–337, 355
 - setting options for, 337
- painting objects, 235, 236–237
 - See also* Live Paint groups
- panels, 33, 39–41
 - groups of, 39
 - hiding/showing, 42
 - menu options in, 44–45
 - moving and docking, 40–41
 - working with, 39–40
 - See also* specific panels
- panning documents, 50
- PANTONE color system, 223, 224
- Paragraph panel, 257–258
- paragraph styles, 262, 273
 - creating and applying, 262–263
 - editing, 265
 - practicing with, 264
- Paragraph Styles panel, 263, 264, 265
- paragraphs
 - changing formatting for, 257–258
 - styles applied to, 262–265
- Paste in Place option, 12, 18
- Paste Remembers Layers option, 292–293, 297
- pasting layers, 292–293, 297
- Pathfinder effects, 130–132, 137
- Pathfinder panel, 130, 131
- paths
 - arrowheads on, 182
 - clipping, 108, 419, 420–421
 - closed, 87
 - compound, 124–125
 - curved, 192–193
 - deselecting, 194, 203
 - drawing, 169–171, 177–178
 - editing, 172–173, 189–190, 204, 336–337
 - explained, 63
 - free-form, 169, 177
 - grouping, 352
 - joining, 117–118, 180–181
 - open, 87, 102, 269
 - reshaping, 133
 - selecting, 189
 - simplifying, 105
 - text on, 269–270
- Pattern brushes, 344–349
 - applying, 344–345, 347–348
 - corners for, 345, 347
 - creating, 345–347
 - editing, 348–349
- Pattern Editing mode, 323–324, 325, 326
- Pattern Options panel, 324, 325
- pattern tile, 324
- patterns, 322–326
 - applying, 322–323, 325–326
 - creating your own, 323–325
 - editing, 326
 - saving a copy of, 325

- patterns (*continued*)
 - swatches for, 322, 325, 346, 348
 - tiling of, 324–325, 346–347, 349
 - PDF file creation, 437
 - Pen tool, 186–203
 - artwork created with, 199–203
 - curves drawn with, 192–195, 209
 - overview on using, 186–187
 - straight lines drawn with, 187–188, 190–191, 209
 - Pencil tool, 177–179
 - paths drawn with, 177–178, 183
 - setting options for, 177, 183
 - straight lines drawn with, 178–179
 - Photoshop effects, 368, 375–376, 383
 - Photoshop images
 - cloud documents as, 7, 418
 - placing in documents, 414–416
 - See also* images
 - Photoshop Import Options dialog box, 415, 416
 - pie widget, 95
 - pins
 - adding, 161–163
 - rotating, 163–164
 - pixel-aligned property, 438
 - pixel grid, 438
 - aligning artwork to, 439–442, 447
 - turning off, 439
 - Pixel Preview, 51, 438
 - Place dialog box, 410, 414, 415, 417
 - placeholder text, 243, 244, 269
 - placing images, 409–411
 - cloud documents, 418
 - multiple images, 417–418
 - Photoshop documents, 414–416
 - point type
 - adding to documents, 243–244
 - converting to area type, 246
 - points
 - corner, 173–174
 - direction, 187, 192, 194
 - smooth, 173, 192
 - width, 134–135
 - See also* anchor points
 - Points mode, 315–316
 - Polygon tool, 97, 98
 - polygons
 - creating, 97–98
 - editing, 98–99
 - positioning artwork, 153
 - PPI (pixels per inch), 412, 413
 - preferences file, 4–5, 31
 - presets
 - Adobe PDF, 437
 - text warp, 270–271
 - previews
 - brush edit, 334
 - modes for viewing, 50–51
 - Pen tool, 188, 192
 - Pixel Preview, 51, 438
 - Previous artboard button, 74, 148
 - process color inks, 223
 - profiles, variable-width, 135
 - Properties panel
 - overview on working with, 38–39
 - positioning artwork using, 153
 - scaling artwork using, 154, 382
 - Puppet Warp tool, 161–164, 165
- ## R
- radial gradients, 301
 - adjusting, 310–312
 - applying to artwork, 309
 - editing colors in, 310
 - radial repeats, 158, 161
 - raster effects, 368, 375–376
 - raster images, 30
 - combining with vector artwork, 409
 - creating Art brushes from, 340–341
 - tracing and converting, 103–105, 111
 - See also* images
 - Rearrange All Artboards dialog box, 147
 - Recolor Artwork dialog box, 18–19, 231–234, 239
 - editing colors with, 18–19, 231–233
 - sampling colors with, 233–234
 - Rectangle tool, 12, 25, 87, 424, 439–440

- rectangles, 87–92
 - creating, 87–88
 - editing, 88–90
 - rounding corners of, 90–92
 - Relink button, 430, 435
 - Remove Brush Stroke button, 338
 - removing
 - assets from Asset Export panel, 444
 - brush strokes from artwork, 338
 - color stops from gradients, 308
 - See also* deleting
 - renaming. *See* naming/renaming
 - reordering. *See* ordering/reordering
 - repeats, 158–161
 - grid and radial, 158, 161
 - mirror, 158–161
 - replacing
 - images, 430, 431
 - symbols, 395–396
 - Reset Essentials command, 31, 43, 44
 - Reshape tool, 133
 - reshaping
 - paths, 133
 - type objects, 261
 - resizing. *See* sizing/resizing
 - resolution, 412, 413
 - resources, Illustrator, 5
 - Reverse Gradient button, 310
 - RGB color mode, 213, 226, 438
 - Rotate tool, 155, 175, 235
 - Rotate View tool, 54, 57
 - rotating
 - canvas, 54
 - gradients, 305
 - groups, 110
 - lines, 102, 175–176
 - objects, 155
 - pins, 163–164
 - shapes, 88, 98, 101
 - rubber band, 188
 - ruler origin, 150, 152, 165
 - rulers
 - artboard vs. global, 150, 165
 - working with guides and, 150–152
- ## S
- sampling
 - appearance attributes, 226
 - colors, 233–234
 - text formatting, 261–262
 - Save a Copy option, 325
 - saving
 - colors as swatches, 216–217, 223
 - documents, 11
 - gradients, 303–304
 - patterns, 325
 - PDF files, 437
 - preferences file, 4
 - selections, 69, 81
 - workspaces, 43–44
 - Scale Strokes & Effects option, 154, 165
 - scaling
 - effects, 154, 165, 381–382
 - objects, 154–155, 156
 - strokes, 154, 165, 381–382
 - user interface, 42
 - See also* sizing/resizing
 - Scissors tool, 115–116, 137
 - scrubbing across paths, 181
 - segments, path, 63, 173, 187
 - selected-art indicator, 283, 291
 - selecting
 - anchor points, 63–64, 189
 - objects, 61–70
 - paths, 189
 - similar text, 7
 - selection indicator, 38, 281, 288
 - Selection tool, 61–63, 65, 81, 264, 271, 396, 439
 - selections
 - bounding box of, 62
 - marquee, 65
 - Outline mode, 69–70
 - saving, 69, 81
 - similar object, 68–69
 - tools for making, 61–64

- Shape Builder tool, 14–15, 127–129, 137, 176
- shape modes, 131–132, 137
- Shaper tool, 37
- shapes, 87–103
 - circles, 94–96
 - combining, 14–15, 126–132
 - creating, 12–13, 126
 - deleting, 127, 128
 - editing, 13–14, 115–125
 - ellipses, 93–94
 - explanation of, 87
 - grouping, 110
 - lines and, 102–103
 - Live, 13, 88, 111
 - masking with, 421–422
 - polygons, 97–99
 - rectangles, 87–92
 - rotating, 88, 98, 101
 - stars, 100–101
 - strokes edited for, 96–97
 - widgets for, 87, 90, 91–92, 99
- shared assets, 6, 397
- Shear tool, 157
- shearing objects, 156–157
- shortcuts. *See* keyboard shortcuts
- Show Activated Fonts button, 252
- Show All Layers command, 290
- Simplify command, 105–106
- sizing/resizing
 - artboards, 144, 165
 - brushes, 350, 353
 - fonts, 254–255
 - gradients, 311
 - See also* scaling
- Smart Guides
 - components of, 87, 191
 - explanation of, 62, 98
 - turning off/on, 97, 98, 190, 191, 394
- smooth color blends, 320–321
- smooth points, 173, 192
 - converting between corner and, 195–197, 206–208, 209
 - corner points distinguished from, 173, 209
- Snap To Grid option, 92
- Snap To Pixel option, 439
- spine of a blend, 319
- spot colors, 223, 224–225
- stacking order, 79, 280, 287
- Star tool, 100, 101
- stars, creating/editing, 100–101
- static symbols, 389
- Status bar, 33, 53
- straight lines
 - combining curves and, 197–198
 - erasing in, 123, 137
 - Pen tool for drawing, 187–188, 209
 - Pencil tool for drawing, 178–179
 - See also* lines
- Stroke panel, 21, 97, 175, 182
- strokes
 - aligning, 21, 97
 - color of, 21, 97, 214
 - dashed line, 175–176
 - editing, 21, 96–97
 - gradients on, 306–308
 - outlining, 121, 137
 - scaling, 154, 165, 381–382
 - text, 366–367
 - variable-width, 7, 134–135
- styles
 - character, 262, 265–267
 - graphic, 376–381
 - paragraph, 262–265
- sublayers, 280
- Substance materials, 6
- Swatch Conflict dialog box, 146
- Swatch Options dialog box, 16, 218, 220
- swatches
 - color, 15–16, 216–221
 - gradient, 303–304
 - pattern, 322, 325, 346, 348
- Swatches panel, 16, 216–217, 220, 222, 224, 304
- Symbol Options dialog box, 391, 392, 393
- Symbol Scruncher tool, 395
- symbol sets, 395

Symbol Sprayer tool, 395
symbolism tools, 395
symbols, 387–396

- adding default, 387–389
- benefits of using, 405
- breaking links to, 393–394
- creating, 392–393
- dynamic, 391
- editing, 390, 391
- explanation of, 387
- instances of, 387, 388–389, 393–394
- layers for, 396
- libraries of, 387, 388
- reordering, 392
- replacing, 395–396
- tools for working with, 395
- viewing names of, 388

Symbols panel, 387, 388–389, 392

T

target icon, 294, 380
text, 23–24, 240–273

- adding, 23, 26, 243–245
- aligning, 259
- area type as, 244–245
- Auto Sizing feature, 246
- character formatting, 256–257
- color applied to, 255
- converting between types of, 246
- creating columns of, 260
- editing with effects, 372
- fills added to, 364–365
- fonts used for, 250–255
- graphic styles applied to, 378
- importing from files, 247
- library assets as, 400
- masking objects with, 422–424
- outlines created from, 272
- paragraph formatting, 257–258
- path-based, 269–270
- placeholder, 243, 244, 269
- point type as, 243–244
- sampling attributes of, 261–262
- selecting similar, 7
- strokes added to, 366
- styles applied to, 262–267

threading, 248–249
warping, 24–25, 270–271, 371
wrapping, 268
See also fonts; type objects
Text Import Options dialog box, 247
threading text, 248–249, 273
tiling

- document, 55–56
- pattern, 324–325, 346–347, 349

tints, color, 225–226, 239
tool tips, 34
toolbar, 33, 34–37

- appearance of, 214
- docking, 36
- extra tools in, 36–37
- resizing and floating, 35
- selecting tools in, 34

tools

- finding extra, 36–37
- selecting hidden, 34
- See also* specific tools

traced artwork, 103–106

- cleaning up, 105–106
- creating, 103–105

Transform Each dialog box, 156
Transform effect, 374
Transform panel, 91
transforming artwork, 17–18, 152–158

- bounding box for, 152–153
- Free Transform tool for, 158
- menu commands for, 157–158
- placing images and, 411–412
- positioning objects, 153
- rotating objects, 155
- scaling objects, 154–155, 156
- shearing objects, 156–157

transparency

- gradient, 313–314
- pattern, 323
- spot colors and, 225

Transparency panel, 323, 365, 424, 425–427
tutorials, Illustrator, 5

- type objects, 244
 - converting between, 246
 - reshaping, 261
 - See also* text
- Type tool, 23, 243, 244, 250, 257, 271, 273

U

- unembedding images, 429
- Unite button, 131
- unlocking
 - layers, 292, 295
 - objects, 67–68, 147
- Update Link button, 401
- updating
 - graphic styles, 379–380
 - Library assets, 401–402
 - symbol instances, 390
- user interface
 - brightness adjustment, 46
 - scaling, 42

V

- variable-width strokes, 7, 134–135
- vector effects, 368
- vector graphics, 30, 409
- vertical alignment, 73, 74, 146, 147, 259
- vertical distribution, 72
- videos
 - on 3D effects, 376
 - on area type auto sizing, 246
 - on fixing missing fonts, 253
 - on Free Transform tool, 158
 - on glyph snapping, 259
 - on Glyphs panel, 258
 - on grid and radial repeats, 161
 - on panning documents, 50
 - on ruler origin, 152
- viewing artwork, 46–51
 - modes for, 50–51
 - panning for, 50
 - rotating the canvas for, 54
 - view commands for, 46–47
 - Zoom tool for, 48–49

W

- Warp effect, 371
- Warp Options dialog box, 270, 371
- warping artwork, 161–164
- warping text, 24–25
 - envelope warp for, 270–271
 - Warp effect for, 371
- Web Edition of book, 3
- web-based resources, 5
- WebP format files, 7
- weight, stroke, 97, 136
- widgets
 - center point, 87
 - corner radius, 15
 - Live Corners, 90, 91–92, 99
 - pie, 95
- width, stroke, 7, 134–135
- Width Point Edit dialog box, 134, 135
- width points, 134–135
- Width tool, 134–135
- Windows commands, 2
- workspaces, 33–45
 - overview of, 33
 - panel features in, 39–41, 44–45
 - Properties panel in, 38–39
 - resetting, 11, 31, 44
 - saving, 43–44
 - switching, 42–43
 - toolbar in, 34–37
- wrapping text, 268

Z

- Zig Zag effect, 26
- Zoom tool, 48–49
- zooming in/out, 46, 48–49